

VIM International Enterprise Co., Ltd.

RIVET NUTS & SPECIAL BOLTS

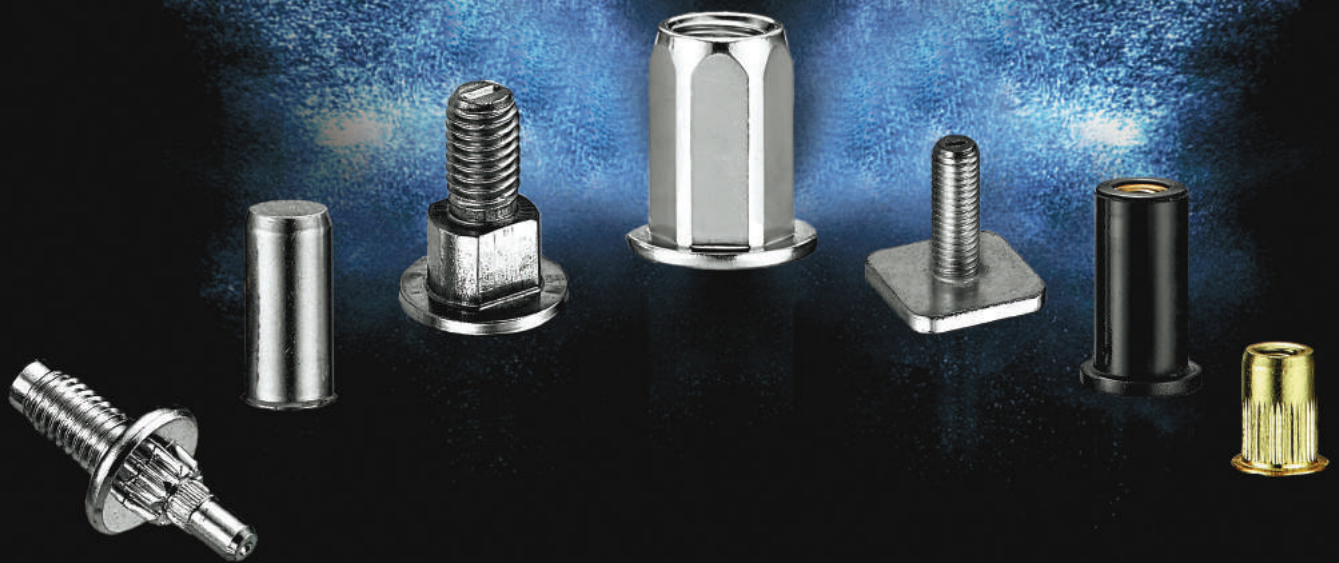

SOLID QUALITY BLIND RIVET NUT



INDEX

P. 04 - 18	STEEL CR⁺³
P. 19 - 26	STAINLESS STEEL
P. 27 - 29	ALUMINUM

QUALITY & CONTROL

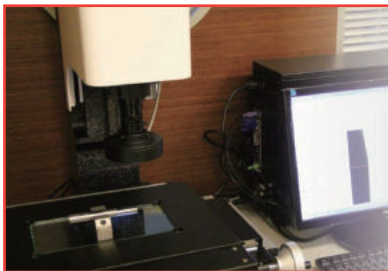

Optical sorting machine



Tensile Strength Machine

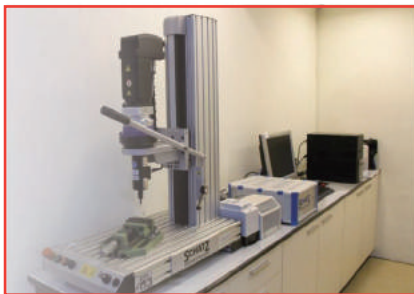

Torque angle sensor

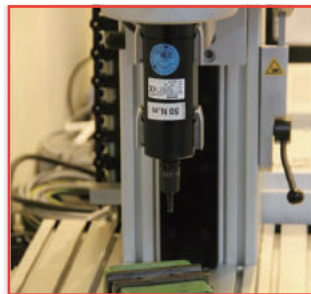

Hardness Tester



Video measuring system



IATF 16949 / ISO 9001:2015 Accredited



profile projector

Equipment & Technology

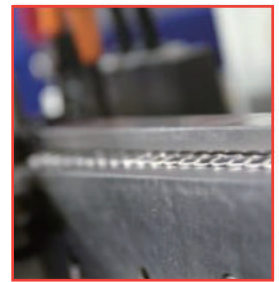
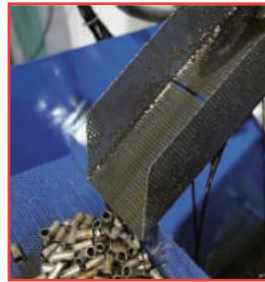

APPLICATIONS

Housings:

Sash, curtain wall, door leaf, fence, window grille, kitchen equipment, steel furnitures, air-conditioning unit, etc.

Household appliances:

Refrigerator, oven, washing machine, TV set, stereo set, etc.

Automobiles/vehicles:

Bus, truck, container car, pass-enger car, railway rolling stock, etc.

Others:

Vending machine, agricultural equipment, toys, electronic part, etc.



BLIND RIVET NUT



Characteristics :

- Open end type
- Closed end type
- Hexagon type
- Square type
- Roulette type

Material :

- Steel
- Stainless Steel
- Aluminum

- Blind application multi-functional fasteners.
- Serves as bolt anchor, material joint and spacer.
- Securely clamps onto both metals and resins.
- Low set up costs and high speed installations.
- Maintenance free alternative to welding, tapping or conventional nut + bolt.
- Can be installed at any stage of assembly process.
- Will not damage or distort painted surfaces.

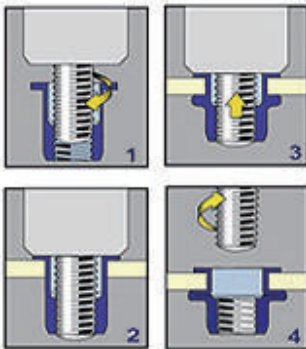

THE BENEFITS OF “SPIN-PULL” TECHNOLOGY

1. Auto thread: Pressure activated mandrel screw automatically threads into insert
2. 1st Stage Trigger ; Pulls mandrel into tool, compressing insert body forming crimped base against material backing
3. 2nd Stage Trigger; Spins mandrel out of installed insert
4. Application: various

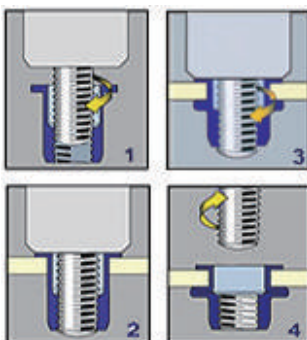

THE BENEFITS OF “SPIN-SPIN” TECHNOLOGY

1. Auto Thread: Pressure activated mandrel screw automatically threads into insert
2. Single Stage Trigger: Turns mandrel screw further into insert, radially compressing body until securely crimped against material backing.
3. Torque Release: Upon reaching a preset torque limit, the mandrel will stop. reverse, and extract itself from the insert.

C SERIES
STEEL CR⁺³ BLIND RIVET NUT
COUNTERSUNK HEAD, OPEN END

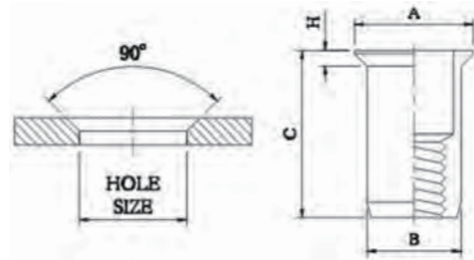

METRIC SIZE :MM

PART NO.	THREAD SIZE	GRIP RANGE	HOLE SIZE+0.1	A±0.3	B max	C±0.3	H±0.2
C325	M3x0.5	1.5-2.5	5	6.50	4.97	10.50	1.00
C435	M4x0.7	1.5-3.5	6	8.50	5.97	11.50	1.50
C450	M4x0.7	3.5-5.0	6	8.50	5.97	13.00	1.50
C540	M5x0.8	1.5-4.0	7	9.50	6.97	13.00	1.50
C555	M5x0.8	4.0-5.5	7	9.50	6.97	14.50	1.50
C645	M6x1.0	1.5-4.5	9	11.50	8.97	16.00	1.50
C660	M6x1.0	4.5-6.0	9	11.50	8.97	17.50	1.50
C845	M8x1.25	1.5-4.5	11	13.50	10.97	18.50	1.50
C860	M8x1.25	4.5-6.0	11	13.50	10.97	20.00	1.50
C1030	M10x1.5	1.5-3.0	13	15.50	12.97	20.50	1.50
C1045	M10x1.5	3.0-4.5	13	15.50	12.97	22.00	1.50
C1060	M10x1.5	4.5-6.0	13	15.50	12.97	23.50	1.50
C1090	M10x1.5	6.0-9.0	13	15.50	12.97	26.50	1.50
C1245	M12x1.75	1.8-4.5	16	19.00	15.97	26.00	1.80
C1075	M12x1.75	4.5-7.5	16	19.00	15.97	26.00	1.80

RK SERIES
STEEL CR⁺³ BLIND RIVET NUT
COUNTERSUNK HEAD, KNURLED BODY, OPEN END

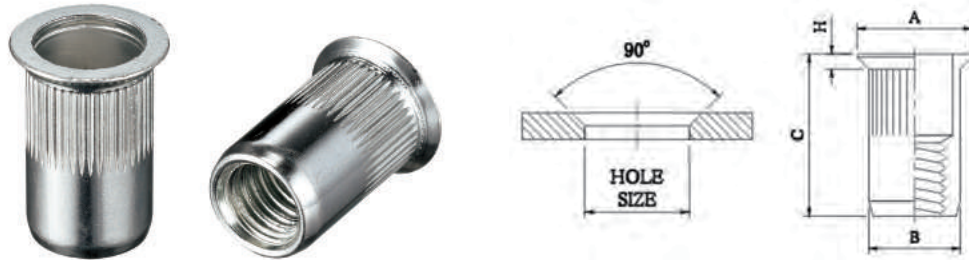

METRIC SIZE :MM

PART NO.	THREAD SIZE	GRIP RANGE	HOLE SIZE+0.1	A±0.3	B max	C±0.3	H±0.2
RK435	M4x0.7	1.5-3.5	6	8.50	5.97	11.50	1.50
RK450	M4x0.7	3.5-5.0	6	8.50	5.97	13.00	1.50
RK540	M5x0.8	1.5-4.0	7	9.50	6.97	13.00	1.50
RK645	M6x1.0	1.5-4.5	9	11.50	8.97	16.00	1.50
RK660	M6x1.0	4.5-6.0	9	11.50	8.97	17.50	1.50
RK845	M8x1.25	1.5-4.5	11	13.50	10.97	18.50	1.50
RK865	M8x1.25	4.5-6.5	11	13.50	10.97	21.00	1.50
RK1045	M10x1.5	1.5-4.5	13	15.50	12.97	22.00	1.50
RK1245	M12x1.75	1.8-4.5	16	18.50	15.97	26.00	1.80
RK1275	M12x1.75	4.5-7.5	16	18.50	15.97	29.00	1.80

R2 SERIES
STEEL CR⁺³ BLIND RIVET NUT
REDUCED COUNTERSUNK HEAD, OPEN END

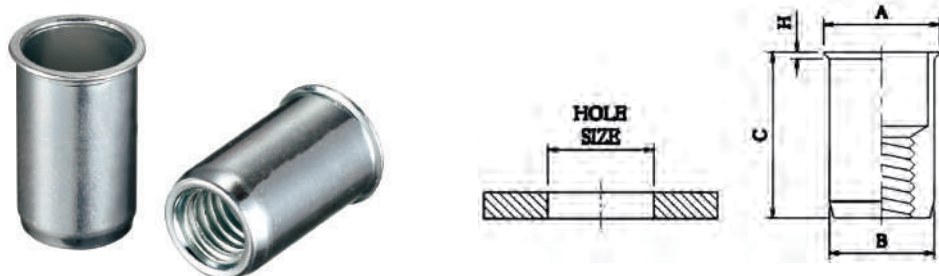

METRIC SIZE :MM

PART NO.	THREAD SIZE	GRIP RANGE	HOLE SIZE+0.1	A±0.3	B max	C±0.3	H±0.2
R2420	M4x0.7	0.5-2.0	6	6.90	5.97	10.00	0.45
R2530	M5x0.8	0.5-3.0	7	8.00	6.97	12.00	0.50
R2630	M6x1.0	0.5-3.0	9	10.00	8.97	15.00	0.50
R2830	M8x1.25	0.5-3.0	11	12.00	10.97	16.00	0.50
R21040	M10x1.5	1.0-4.5	13	14.10	12.97	20.50	0.70

R SERIES

STEEL CR⁺³ BLIND RIVET NUT

REDUCED HEAD, ROUND SHANK BODY, OPEN END

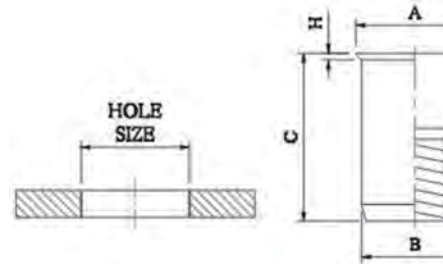

METRIC SIZE :MM

PART NO.	THREAD SIZE	GRIP RANGE	HOLE SIZE+0.15	A±0.3	B max	C±0.38	H±0.13
R315	M3x0.5	0.5-1.5	4.80	5.30	4.72	8.80	0.40
R420	M4x0.7	0.5-2.0	6.35	7.20	6.35	10.40	0.45
R530	M5x0.8	0.5-3.0	7.11	8.10	7.10	12.00	0.50
R630	M6x1.0	0.7-3.0	9.60	10.50	9.50	15.00	0.60
R830	M8x1.25	0.7-3.0	10.60	11.50	10.50	16.00	0.50
R1040	M10x1.5	1.0-4.0	12.70	13.90	12.69	19.00	0.70

RK2 SERIES

STEEL CR⁺³ BLIND RIVET NUT

REDUCED HEAD, ROUND SHANK WITH KNURLED BODY, OPEN END

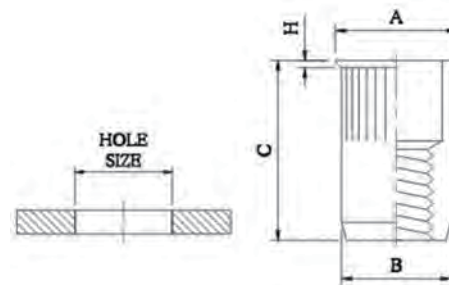

METRIC SIZE :MM

PART NO.	THREAD SIZE	GRIP RANGE	HOLE SIZE+0.15	A±0.3	B max	C±0.38	H±0.13
RK2315	M3x0.5	0.5-1.5	4.80	5.30	4.72	8.80	0.40
RK2420	M4x0.7	0.5-2.0	6.35	7.20	6.35	10.40	0.45
RK2530	M5x0.8	0.5-3.0	7.11	8.10	7.10	12.00	0.50
RK2630	M6x1.0	0.7-3.0	9.60	10.60	9.50	15.00	0.50
RK2830	M8x1.25	0.7-3.0	10.60	11.50	10.50	16.00	0.50
RK21040	M10x1.5	1.0-4.0	12.70	13.80	12.69	21.50	0.60

AK SERIES

STEEL CR⁺³ BLIND RIVET NUT

REDUCED HEAD, ROUND SHANK WITH KNURLED BODY, OPEN END

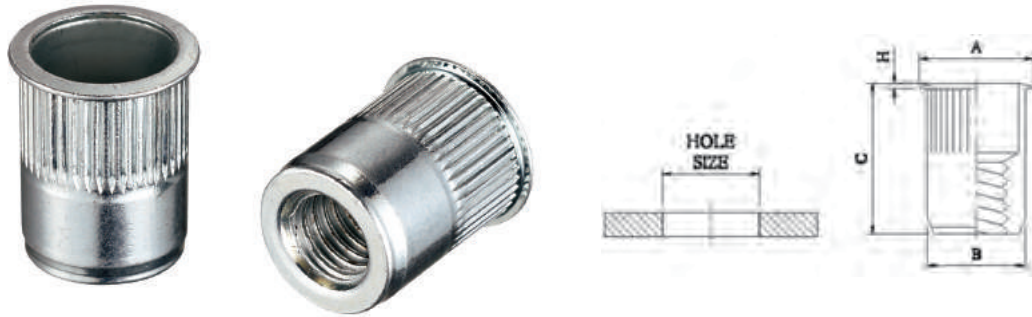

METRIC SIZE :MM

PART NO.	THREAD SIZE	GRIP RANGE	HOLE SIZE+0.15	A±0.3	B max	C±0.38	H±0.13
AK420	M4x0.7	0.5-2.0	6.75	7.87	6.73	11.15	0.48
AK433	M4x0.7	2.0-3.3	6.75	7.87	6.73	12.40	0.48
AK533	M5x0.8	0.5-3.3	7.60	8.64	7.52	12.55	0.48
AK557	M5x0.8	3.3-5.7	7.60	8.64	7.52	15.30	0.48
AK642	M6x1.0	0.7-4.2	10.00	11.50	9.91	15.25	0.55
AK666	M6x1.0	4.2-6.6	10.00	11.50	9.91	17.80	0.55
AK838	M8x1.25	0.7-3.8	13.50	15.10	13.46	18.08	0.55
AK879	M8x1.25	3.8-7.9	13.50	15.10	13.46	21.00	0.55
AK1038	M10x1.5	0.7-3.8	13.50	15.10	13.46	18.08	0.55
AK1079	M10x1.5	3.8-7.9	13.50	15.10	13.46	21.00	0.55

METRIC SIZE :INCH

PART NO.	THREAD SIZE	GRIP RANGE	HOLE SIZE+.006	A±.012	B max	C±.015	H±.005
AK632-80	6-32	.020-.080	.2656	.310	.265	.439	.019
AK632-130	6-32	.080-.130	.2656	.310	.265	.489	.019
AK832-80	8-32	.020-.080	.2656	.310	.265	.439	.019
AK832-130	8-32	.080-.130	.2656	.310	.265	.489	.019
AK1024-130	10-24	.020-.130	.2969	.340	.296	.494	.019
AK1024-225	10-24	.130-.225	.2969	.340	.296	.604	.019
AK1032-130	10-32UNF	.020-.130	.2969	.340	.296	.494	.019
AK1032-225	10-32UNF	.130-.225	.2969	.340	.296	.604	.019
AK1/4-165	1/4-20	.027-.165	.3906	.455	.390	.602	.022
AK1/4-260	1/4-20	.165-.260	.3906	.455	.390	.702	.022
AK5/16-150	5/16-18	.027-.150	.5312	.595	.530	.712	.022
AK5/16-312	5/16-18	.150-.312	.5312	.595	.530	.827	.022
AK3/8-150	3/8-16	.027-.150	.5312	.595	.530	.712	.022
AK3/8-312	3/8-16	.150-.312	.5312	.595	.530	.827	.022

AL SERIES

STEEL CR⁺³ BLIND RIVET NUT

REDUCED HEAD, ROUND SHANK WITH KNURLED BODY, OPEN END

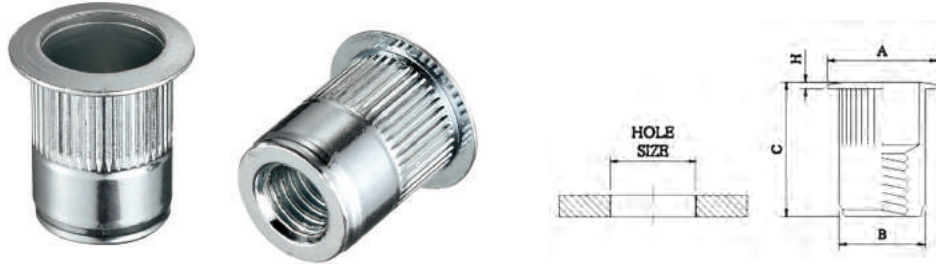

METRIC SIZE :MM

PART NO.	THREAD SIZE	GRIP RANGE	HOLE SIZE+0.15	A±0.3	B max	C±0.38	H±0.13
AL420	M4x0.7	0.5-2.0	6.75	9.91	6.73	11.43	0.76
AL433	M4x0.7	2.0-3.3	6.75	9.91	6.73	12.67	0.76
AL533	M5x0.8	0.5-3.3	7.60	10.50	7.52	12.80	0.76
AL557	M5x0.8	3.3-5.7	7.60	10.50	7.52	15.60	0.76
AL642	M6x1.0	0.7-4.2	10.00	12.70	9.91	15.50	0.76
AL666	M6x1.0	4.2-6.6	10.00	12.70	9.91	18.00	0.76
AL838	M8x1.25	0.7-3.8	13.50	17.40	13.46	18.42	0.89
AL879	M8x1.25	3.8-7.9	13.50	17.40	13.46	21.35	0.89
AL1038	M10x1.5	0.7-3.8	13.50	17.40	13.46	18.40	0.89
AL1079	M10x1.5	3.8-7.9	13.50	17.40	13.46	21.30	0.89

METRIC SIZE :INCH

PART NO.	THREAD SIZE	GRIP RANGE	HOLE SIZE+.006	A±.012	B max	C±.015	H±.005
AL632-80	6-32	.020-.080	.2656	.390	.265	.450	.030
AL632-130	6-32	.080-.130	.2656	.390	.265	.500	.030
AL832-80	8-32	.020-.080	.2656	.390	.265	.450	.030
AL832-130	8-32	.080-.130	.2656	.390	.265	.500	.030
AL1024-130	10-24	.020-.130	.2969	.415	.296	.505	.030
AL1024-225	10-24	.130-.225	.2969	.415	.296	.615	.030
AL1032-130	10-32UNF	.020-.130	.2969	.415	.296	.505	.030
AL1032-225	10-32UNF	.130-.225	.2969	.415	.296	.615	.030
AL1/4-165	1/4-20	.027-.165	.3906	.500	.390	.610	.030
AL1/4-260	1/4-20	.165-.260	.3906	.500	.390	.710	.030
AL5/16-150	5/16-18	.027-.150	.5312	.685	.530	.725	.035
AL5/16-312	5/16-18	.150-.312	.5312	.685	.530	.840	.035
AL3/8-150	3/8-16	.027-.150	.5312	.685	.530	.725	.035
AL3/8-312	3/8-16	.150-.312	.5312	.685	.530	.840	.035

RK3-CL SERIES

STEEL CR⁺³ BLIND RIVET NUT

REDUCED HEAD, ROUND SHANK WITH KNURLED BODY, CLOSED END

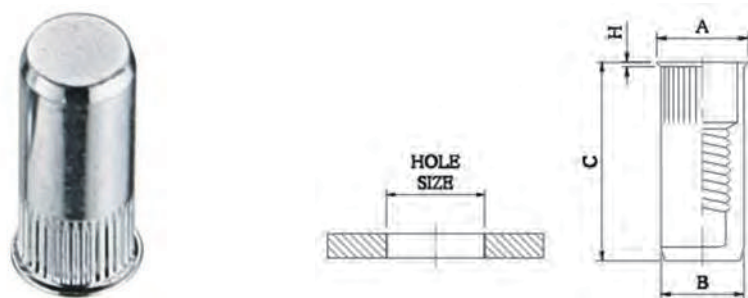

METRIC SIZE :MM

PART NO.	THREAD SIZE	GRIP RANGE	HOLE SIZE+0.1	A±0.3	B max	C±0.3	H±0.2
RK3-CL425	M4x0.7	0.5-2.5	5	6.80	5.97	15.00	0.50
RK3-CL530	M5x0.8	0.7-3.0	6	8.00	6.97	18.00	0.50
RK3-CL630	M6x1.0	0.7-3.0	9	9.90	8.97	21.50	0.50
RK3-CL835	M8x1.25	0.7-3.5	11	12.00	10.97	22.50	0.50
RK3-CL1040	M10x1.5	1.0-4.0	13	14.20	12.97	28.00	0.50

RK3 SERIES

STEEL CR⁺³ BLIND RIVET NUT

FLAT HEAD, ROUND SHANK WITH KNURLED BODY, OPEN END

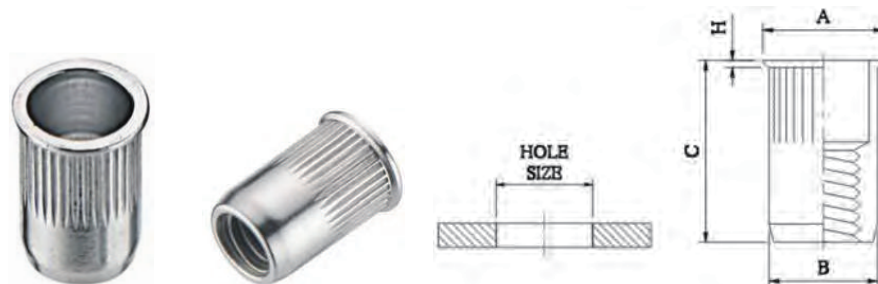

METRIC SIZE :MM

PART NO.	THREAD SIZE	GRIP RANGE	HOLE SIZE+0.1	A±0.3	B max	C±0.3	H±0.2
RK3320	M3x0.5	0.5-2.0	5	5.80	4.97	9.00	0.50
RK3330	M3x0.5	2.0-3.5	5	6.00	4.97	10.50	0.40
RK3420	M4x0.7	0.5-2.0	6	7.00	5.97	9.95	0.45
RK3440	M4x0.7	2.0-4.0	6	7.00	5.97	12.00	0.45
RK3530	M5x0.8	0.5-3.0	7	8.00	6.97	12.00	0.50
RK3540	M5x0.8	2.5-4.0	7	8.00	6.97	14.00	0.50
RK3630	M6x1.0	0.7-3.0	9	10.00	8.97	15.00	0.50
RK3650	M6x1.0	3.0-5.0	9	10.00	8.97	17.00	0.50
RK3660	M6x1.0	3.0-6.0	9	10.00	8.97	17.50	0.50
RK3830	M8x1.25	0.7-3.0	11	12.00	10.97	16.00	0.50
RK3855	M8x1.25	3.0-5.5	11	12.00	10.97	18.50	0.50
RK31045	M10x1.5	1.0-4.5	13	14.10	12.97	20.50	0.60
RK31060	M10x1.5	3.0-6.0	13	14.10	12.97	23.50	0.60
RK31240	M12x1.75	1.0-4.0	16	17.15	15.97	24.00	0.60
RK31260	M12x1.75	4.0-6.0	16	17.15	15.97	27.00	0.60

F SERIES
STEEL CR⁺³ BLIND RIVET NUT
FLAT HEAD, ROUND SHANK BODY, OPEN END



METRIC SIZE :MM

PART NO.	THREAD SIZE	GRIP RANGE	HOLE SIZE+0.15	A±0.3	B max	C±0.38	H±0.13
F520	M5x0.8	0.25-2.0	6.75	10.00	6.30	14.00	1.00
F620	M6x1.0	0.5-2.0	8.43	13.40	8.43	17.40	1.50
F650	M6x1.0	3.5-5.0	8.43	13.40	8.43	20.00	1.50
F1030	M10x1.5	1.0-3.0	13.50	19.50	12.44	22.20	2.23

METRIC SIZE :INCH

PART NO.	THREAD SIZE	GRIP RANGE	HOLE SIZE+.006	A±.012	B max	C±.015	H±.005
F632-75	6-32	.010-.075	.189	.325	.189	.470	.032
F632-120	6-32	.075-.120	.189	.325	.189	.532	.032
F832-75	8-32	.010-.075	.221	.357	.221	.470	.032
F832-75	8-32	.075-.120	.221	.357	.221	.432	.032
F1032-80	10-32UNF	.010-0.80	.250	.406	.250	.569	.038
F1032-130	10-32UNF	.080-.130	.250	.406	.250	.632	.038
F1/4-80	1/4-20	.020-0.80	.332	.475	.332	.683	.058
F1/4-140	1/4-20	.080-.140	.332	.475	.332	.745	.058
F1/4-200	1/4-20	.140-.200	.332	.475	.332	.808	.058
F5/16-125	5/16-18	.030-.125	.413	.665	.413	.812	.062
F5/16-200	5/16-18	.125-.200	.413	.665	.413	.937	.062
F3/8-155	3/8-16	.030-.115	.490	.781	.490	.932	.088
F3/8-200	3/8-16	.115-.200	.490	.781	.490	1.026	.088
F1/2-150	1/2-13	.050-.150	.625	.906	.625	.991	.085

KK SERIES

STEEL CR⁺³ BLIND RIVET NUT FLAT HEAD, ROUND SHANK BODY, OPEN END

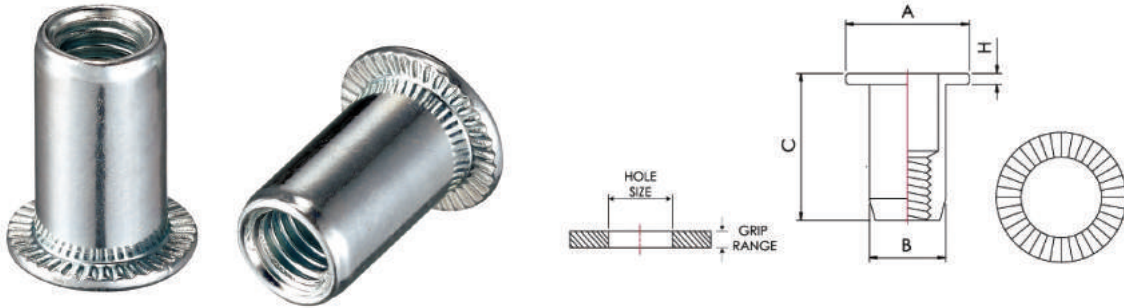

METRIC SIZE :MM

PART NO.	THREAD SIZE	GRIP RANGE	HOLE SIZE+0.1	A±0.3	B max	C±0.3	H±0.2
KK320	M3x0.5	0.5-2.0	5	8.00	4.97	9.50	0.70
KK425	M4x0.7	0.5-2.5	6	9.00	5.97	11.20	0.80
KK530	M5x0.8	0.5-3.0	7	10.00	6.97	12.80	1.00
KK630	M6x1.0	0.7-3.0	9	13.00	8.97	16.00	1.50
KK650	M6x1.0	3.0-5.0	9	13.00	8.97	18.50	1.50
KK830	M8x1.25	0.7-3.0	11	15.00	10.97	18.00	1.50
KK1035	M10x1.5	1.0-3.5	13	17.00	12.97	20.00	1.50

KK-CL SERIES

STEEL CR⁺³ BLIND RIVET NUT FLAT HEAD, ROUND SHANK BODY, CLOSED END

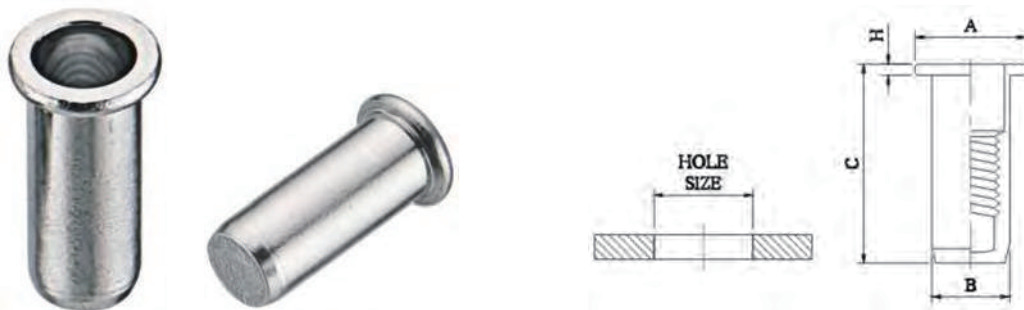

METRIC SIZE :MM

PART NO.	THREAD SIZE	GRIP RANGE	HOLE SIZE+0.1	A±0.3	B max	C±0.3	H±0.2
KK-CL425	M4x0.7	0.5-2.5	6	9.00	5.97	16.50	0.80
KK-CL530	M5x0.8	0.5-3.0	7	10.00	6.97	18.00	1.00
KK-CL630	M6x1.0	0.7-3.0	9	13.00	8.97	23.50	1.60
KK-CL830	M8x1.25	0.7-3.0	11	16.00	10.97	26.00	1.50

FK2 SERIES

STEEL CR⁺³ BLIND RIVET NUT

LARGE FLANGE WITH KNURLED BODY, OPEN END

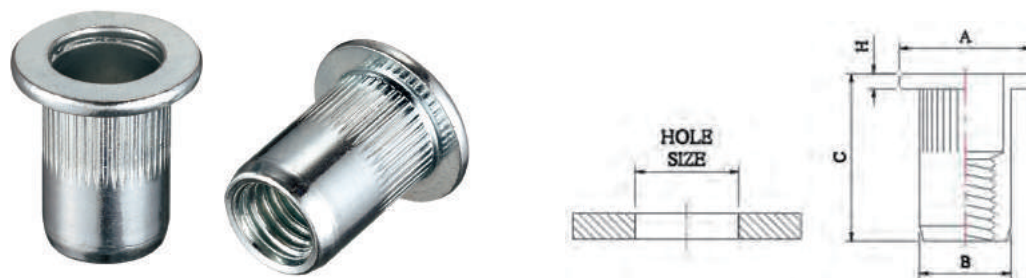

METRIC SIZE :MM

PART NO.	THREAD SIZE	GRIP RANGE	HOLE SIZE+0.1	A±0.3	B max	C±0.3	H±0.2
FK2320	M3x0.5	0.5-2.0	5	8.00	4.97	10.50	0.70
FK2425	M4x0.7	0.5-2.5	6	9.00	5.97	11.00	0.80
FK2440	M4x0.7	2.5-4.0	6	9.00	5.97	12.50	0.80
FK2530	M5x0.8	0.5-3.0	7	10.00	6.97	13.00	1.00
FK2545	M5x0.8	3.0-4.5	7	10.00	6.97	14.50	1.00
FK2630	M6x1.0	0.7-3.0	9	13.00	8.97	16.50	1.50
FK2650	M6x1.0	3.0-5.0	9	13.00	8.97	18.50	1.50
FK2685	M6x1.0	6.0-8.5	9	13.00	8.97	23.00	1.50
FK2830	M8x1.25	0.7-3.0	11	16.00	10.97	17.50	1.50
FK2855	M8x1.25	3.0-5.5	11	16.00	10.97	21.00	1.50
FK21045	M10x1.5	1.0-4.5	13	19.00	12.97	24.00	2.00
FK21050	M10x1.5	4.5-6.0	13	19.00	12.97	25.50	2.00
FK21250	M12x1.75	1.0-5.0	16	23.00	15.97	27.00	2.00

FK3 SERIES

STEEL CR⁺³ BLIND RIVET NUT

LARGE FLANGE WITH KNURLED BODY, AND WAISTLINE, OPEN END

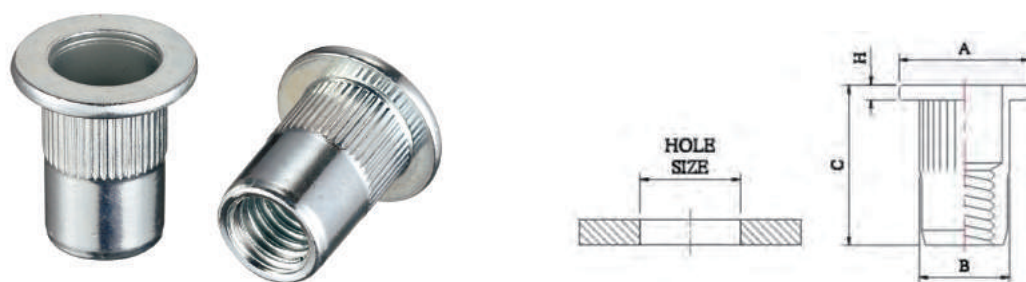

METRIC SIZE :MM

PART NO.	THREAD SIZE	GRIP RANGE	HOLE SIZE+0.1	A±0.3	B max	C±0.3	H±0.2
FK3320	M3x0.5	0.5-2.0	5	8.00	4.97	10.50	0.70
FK3425	M4x0.7	0.5-2.0	6	9.00	5.97	11.00	0.80
FK3530	M5x0.8	0.5-3.0	7	10.00	6.97	13.00	1.00
FK3630	M6x1.0	0.5-3.0	9	13.00	8.97	16.00	1.50
FK3835	M8x1.25	0.5-3.0	11	16.00	10.97	17.50	1.50
FK31040	M10x1.5	1.0-4.0	13	19.00	12.97	24.00	2.00

FK2-CL SERIES

STEEL CR⁺³ BLIND RIVET NUT

LARGE FLANGE WITH KNURLED BODY, CLOSED END

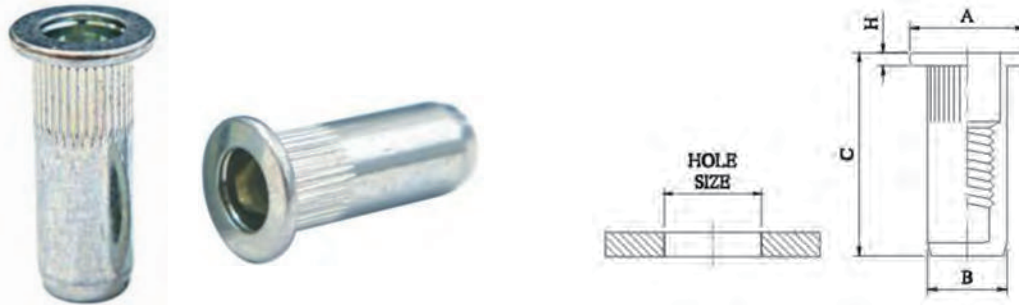

METRIC SIZE :MM

PART NO.	THREAD SIZE	GRIP RANGE	HOLE SIZE+0.1	A±0.3	B max	C±0.3	H±0.2
FK2-CL425	M4x0.7	0.5-2.5	6	9.00	5.97	16.50	0.80
FK2-CL530	M5x0.8	0.5-3.0	7	10.00	6.97	19.00	1.00
FK2-CL630	M6x1.0	0.7-3.0	9	13.00	8.97	23.00	1.50
FK2-CL830	M8x1.25	0.7-3.0	11	16.00	10.97	26.00	1.50
FK2-CL1045	M10x1.5	1.0-4.5	13	19.00	12.97	30.00	2.00

AL-CL SERIES

STEEL CR⁺³ BLIND RIVET NUT

ROUND SHANK, LARGE FLANGE WITH KNURLED BODY, CLOSED END

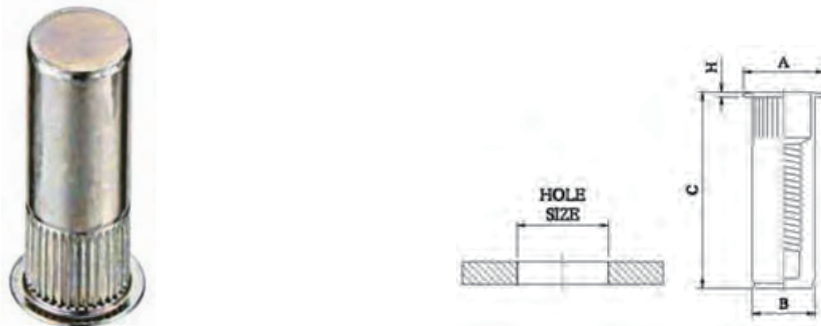

METRIC SIZE :MM

PART NO.	THREAD SIZE	GRIP RANGE	HOLE SIZE+0.15	A±0.3	B max	C±0.38	H±0.13
AL-CL533	M5x0.8	0.5-3.3	7.60	10.50	7.52	25.90	0.76
AL-CL557	M5x0.8	3.3-5.7	7.60	10.50	7.52	25.90	0.76
AL-CL642	M6x1.0	0.7-4.2	10.00	12.70	9.91	31.00	0.76
AL-CL666	M6x1.0	4.2-6.6	10.00	12.70	9.91	31.00	0.76
AL-CL838	M8x1.25	0.7-3.8	13.50	17.40	13.46	36.20	0.89
AL-CL879	M8x1.25	3.8-7.9	13.50	17.40	13.46	36.20	0.89

METRIC SIZE :INCH

PART NO.	THREAD SIZE	GRIP RANGE	HOLE SIZE+.006	A±.012	B max	C±.015	H±.005
AL-CL632-80	6-32	.020-.080	.2656	.390	.265	.770	.030
AL-CL632-130	6-32	.080-.130	.2656	.390	.265	.770	.030
AL-CL832-80	8-32	.020-.080	.2656	.390	.265	.770	.030
AL-CL832-130	8-32	.080-.130	.2656	.390	.265	.770	.030
AL-CL1024-130	10-24	.020-.130	.2969	.415	.296	1.020	.030
AL-CL1024-225	10-24	.130-.225	.2969	.415	.296	1.020	.030
AL-CL1032-130	10-32UNF	.020-.130	.2969	.415	.296	1.020	.030
AL-CL1032-225	10-32UNF	.130-.225	.2969	.415	.296	1.020	.030
AL-CL1/4-165	1/4-20	.027-.165	.3906	.500	.390	1.220	.030
AL-CL1/4-260	1/4-20	.165-.260	.3906	.500	.390	1.220	.030

RSH2 SERIES

STEEL CR⁺³ BLIND RIVET NUT

COUNTERSUNK HEAD, SEMI-HEX REDUCED, OPEN END

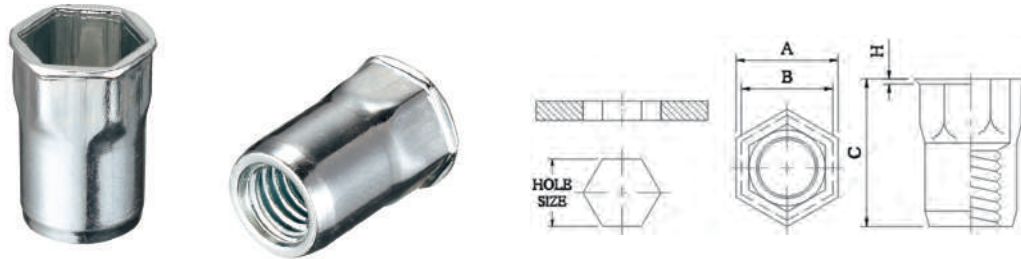

METRIC SIZE :MM

PART NO.	THREAD SIZE	GRIP RANGE	HOLE SIZE+0.1	A±0.3	B max	C±0.3	H±0.2
RSH2330	M3x0.5	1.5-3.0	5	5.80	4.97	10.00	0.50
RSH2420	M4x0.7	0.5-2.0	6	6.80	5.97	10.50	0.40
RSH2530	M5x0.8	0.5-3.0	7	8.00	6.97	11.70	0.50
RSH2630	M6x1.0	0.5-3.0	9	10.00	8.97	14.50	0.50
RSH2830	M8x1.25	0.5-3.0	11	12.00	10.97	16.50	0.50
RSH21035	M10x1.5	1.0-3.5	13	14.00	12.97	20.00	0.80
RSH21060	M10x1.5	3.5-6.0	13	14.00	12.97	24.00	0.80

RSH SERIES

STEEL CR⁺³ BLIND RIVET NUT

REDUCED HEAD, SEMI-HEX BODY, OPEN END

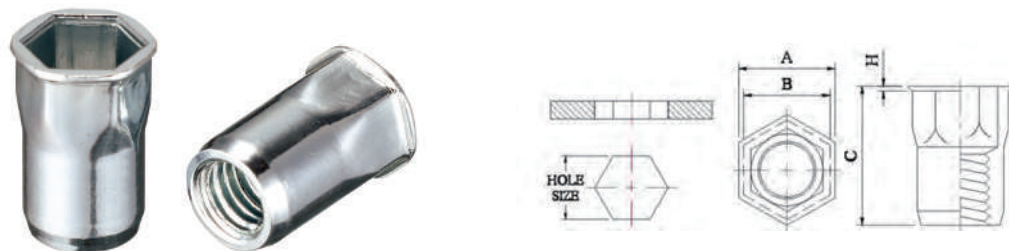

METRIC SIZE :MM

PART NO.	THREAD SIZE	GRIP RANGE	HOLE SIZE+0.15	A±0.3	B max	C±0.38	H±0.13
RSH425	M4x0.7	0.5-2.5	6.40	7.00	6.35	10.40	0.40
RSH533	M5x0.8	0.5-3.0	7.11	8.10	7.10	12.00	0.50
RSH632	M6x1.0	0.7-3.2	9.60	10.50	9.50	14.50	0.50
RSH650	M6x1.0	3.0-5.0	9.60	10.50	9.50	16.00	0.50
RSH832	M8x1.25	0.7-3.2	10.60	11.50	10.50	16.00	0.50
RSH1035	M10x1.5	1.0-3.5	12.70	14.00	12.70	18.80	0.60
RSH1040	M10x1.5	1.0-4.0	12.70	14.00	12.70	22.50	0.60

RSH2-CL SERIES

STEEL CR⁺³ BLIND RIVET NUT REDUCED HEAD, SEMI-HEX BODY, CLOSED END

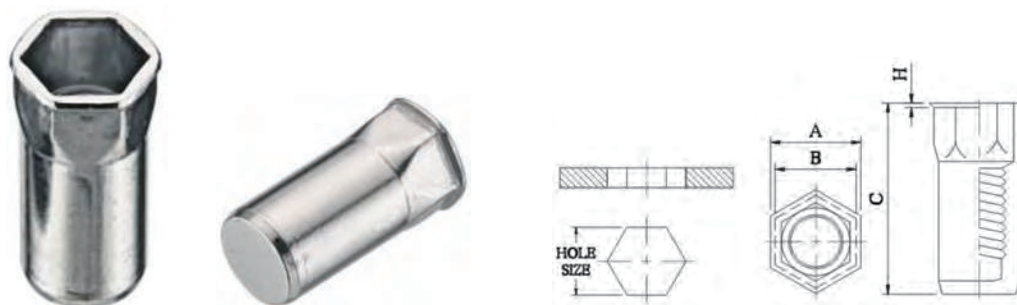

METRIC SIZE :MM

PART NO.	THREAD SIZE	GRIP RANGE	HOLE SIZE+0.1	A±0.3	B max	C±0.3	H±0.2
RSH2-CL420	M4x0.7	0.5-2.0	6	7.00	5.97	16.00	0.50
RSH2-CL545	M5x0.8	0.5-3.0	7	8.00	6.97	18.20	0.50
RSH2-CL630	M6x1.0	0.5-3.0	9	10.00	8.97	21.20	0.50
RSH2-CL830	M8x1.25	0.5-3.0	11	12.00	10.97	24.00	0.60

FSH SERIES

STEEL CR⁺³ BLIND RIVET NUT FLAT HEAD, SEMI-HEX BODY, OPEN END

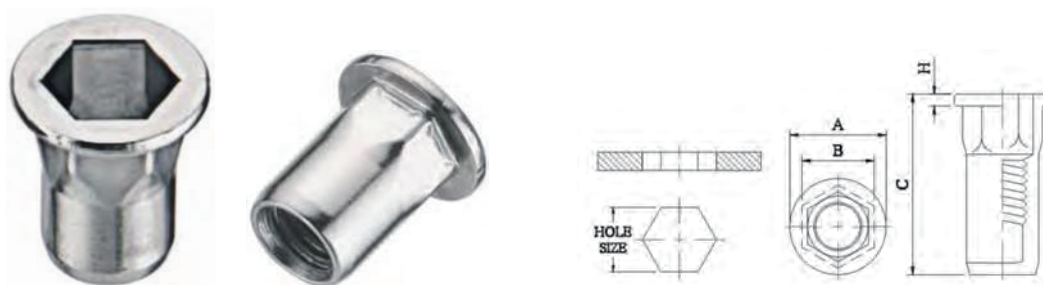

METRIC SIZE :MM

PART NO.	THREAD SIZE	GRIP RANGE	HOLE SIZE+0.1	A±0.3	B max	C±0.3	H±0.2
FSH445	M4x0.7	0.5-2.5	6	9.00	5.97	11.00	0.80
FSH530	M5x0.8	0.5-3.0	7	10.00	6.97	13.80	1.00
FSH630	M6x1.0	0.7-3.0	9	13.00	8.97	16.00	1.50
FSH830	M8x1.25	0.5-3.0	11	16.00	10.97	18.00	1.50
FSH1030	M10x1.5	0.5-3.0	13	19.00	12.97	21.00	2.00
FSH1045	M10x1.5	1.0-4.5	13	19.00	12.97	24.00	2.00

FSH2 SERIES

STEEL CR⁺³ BLIND RIVET NUT

LARGE FLANGE, FLAT HEAD, SEMI-HEX BODY, OPEN END

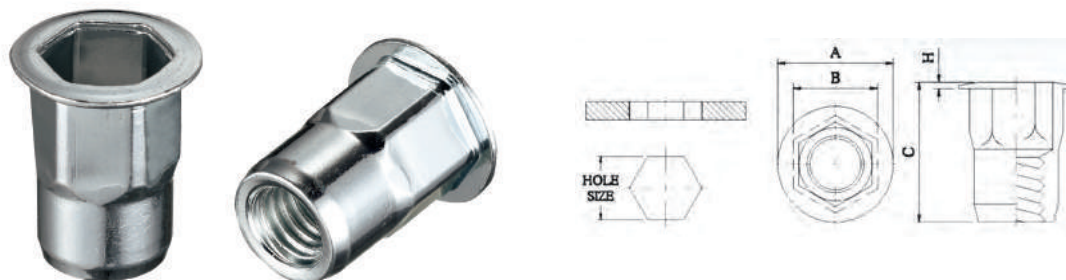

METRIC SIZE :MM

PART NO.	THREAD SIZE	GRIP RANGE	HOLE SIZE+0.15	A±0.3	B max	C±0.38	H±0.13
FSH2420	M4x0.7	0.5-2.0	6.35	9.50	6.33	10.50	0.68
FSH2433	M4x0.7	2.0-3.3	6.35	9.50	6.33	11.70	0.68
FSH2533	M5x0.8	0.5-3.3	7.14	9.91	7.10	11.80	0.68
FSH2557	M5x0.8	3.3-5.7	7.14	9.91	7.10	14.30	0.68
FSH2642	M6x1.0	0.7-4.2	9.53	12.97	9.50	15.60	0.75
FSH2666	M6x1.0	4.2-6.6	9.53	12.97	9.50	18.15	0.75
FSH2838	M8x1.25	0.7-3.8	12.70	16.64	12.67	18.30	0.89
FSH2879	M8x1.25	3.8-7.9	12.70	16.64	12.67	22.35	0.89
FSH21038	M10x1.5	0.7-3.8	12.70	16.64	12.67	18.30	0.89
FSH21079	M10x1.5	3.8-7.9	12.70	16.64	12.67	22.35	0.89

METRIC SIZE :INCH

PART NO.	THREAD SIZE	GRIP RANGE	HOLE SIZE+.006	A±.012	B max	C±.015	H±.005
FSH2632-80	6-32	.020-.080	.250	.375	.249	.412	.027
FSH2832-80	8-32	.020-.080	.250	.375	.249	.412	.027
FSH2832-130	8-32	.080-.130	.250	.375	.249	.462	.027
FSH21024-130	10-24	.020-.130	.281	.390	.280	.462	.027
FSH21032-130	10-32 UNF	.020-.130	.281	.390	.280	.462	.027
FSH21032-225	10-32 UNF	.130-.225	.281	.390	.280	.562	.027
FSH21/4-165	1/4-20	.027-.165	.375	.510	.374	.615	.030
FSH21/4-260	1/4-20	.165-.260	.375	.510	.374	.715	.030
FSH25/16-150	5/16-18	.027-.150	.500	.655	.499	.720	.035
FSH25/16-312	5/16-18	.150-.312	.500	.655	.499	.880	.035
FSH23/8-150	3/8-16	.027-.150	.500	.655	.499	.720	.035
FSH23/8-312	3/8-16	.150-.312	.500	.655	.499	.880	.035

FSH2-CL SERIES

STEEL CR⁺³ BLIND RIVET NUT

LARGE FLANGE, FLAT HEAD, SEMI-HEX BODY, CLOSED END

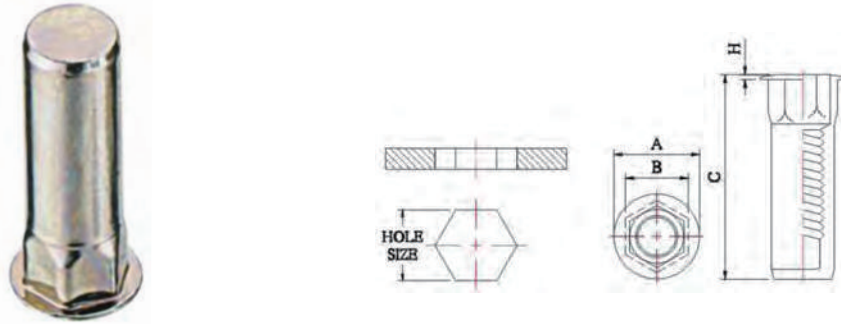

METRIC SIZE :INCH

PART NO.	THREAD SIZE	GRIP RANGE	HOLE SIZE+.006	A±.012	B max	C±.015	H±.005
FSH2-CL632-80	6-32	.020-.080	.250	.375	.249	.767	.027
FSH2-CL832-80	8-32	.020-.080	.250	.375	.249	.767	.027
FSH2-CL1024-130	10-24	.020-.130	.281	.390	.280	1.057	.027
FSH2-CL1032-130	10-32UNF	.020-.130	.281	.390	.280	1.057	.027
FSH2-CL1/4-165	1/4-20	.027-.165	.375	.510	.374	1.220	.030

RFH SERIES

STEEL CR⁺³ BLIND RIVET NUT

FLAT HEAD, FULL HEXAGON BODY, OPEN BODY

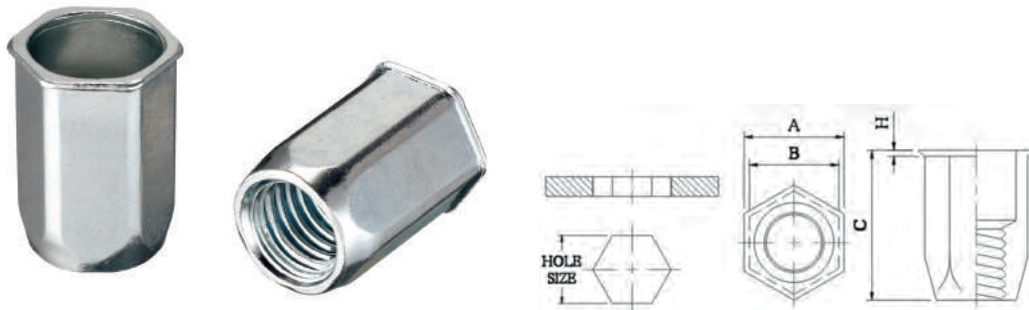

METRIC SIZE :MM

PART NO.	THREAD SIZE	GRIP RANGE	HOLE SIZE+0.1	A±0.3	B max	C±0.3	H±0.2
RFH315	M3x0.5	0.3-1.5	5	5.80	4.97	8.50	0.50
RFH425	M4x0.7	0.5-2.5	6	6.90	5.97	10.00	0.50
RFH530	M5x0.8	0.5-3.0	7	8.00	6.97	12.00	0.60
RFH630	M6x1.0	0.5-3.0	9	10.00	8.97	15.00	0.60
RFH655	M6x1.0	3.0-5.5	9	10.00	8.97	18.00	0.60
RFH835	M8x1.25	0.7-3.5	11	12.00	10.97	17.50	0.60
RFH1035	M10x1.5	1.0-3.5	13	14.50	12.97	22.50	1.00
RFH1045	M10x1.5	1.0-4.5	13	14.50	12.97	23.00	1.00
RFH1060	M10x1.5	3.5-6.0	13	14.50	12.97	25.00	1.00
RFH1235	M12x1.75	1.0-3.5	16	18.25	15.97	25.00	0.90
RFH1265	M12x1.75	3.5-6.5	16	18.25	15.97	28.00	0.90

RFH-CL SERIES

STEEL CR⁺³ BLIND RIVET NUT

REDUCED HEAD, FULL HEXAGON BODY, CLOSED END

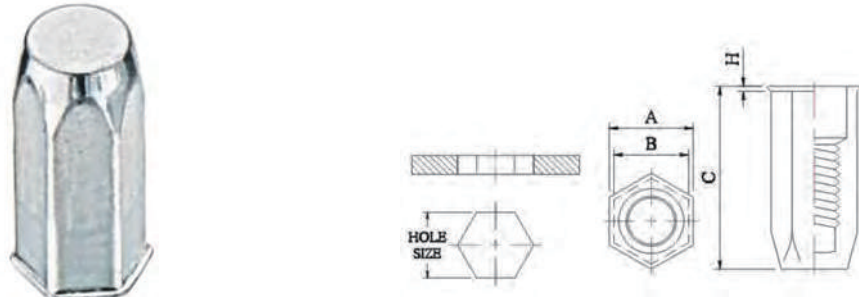

METRIC SIZE :MM

PART NO.	THREAD SIZE	GRIP RANGE	HOLE SIZE+0.1	A±0.3	B max	C±0.3	H±0.2
RFH-CL425	M4x0.7	0.5-2.5	6	6.90	5.97	16.00	0.50
RFH-CL530	M5x0.8	0.5-3.0	7	8.00	6.97	20.00	0.60
RFH-CL630	M6x1.0	0.5-3.0	9	10.00	8.97	22.00	0.60
RFH-CL835	M8x1.25	0.5-3.5	11	12.00	10.97	25.50	0.60
RFH-CL860	M8x1.25	3.0-6.0	11	12.00	10.97	28.00	0.60
RFH-CL1035	M10x1.5	1.0-3.5	13	14.00	12.97	28.00	0.90

R2-S SERIES

STAINLESS STEEL 302,304,306, BLIND RIVET NUT,
REDUCED COUNTERSUNK HEAD, ROUND SHANK BODY, OPEN END

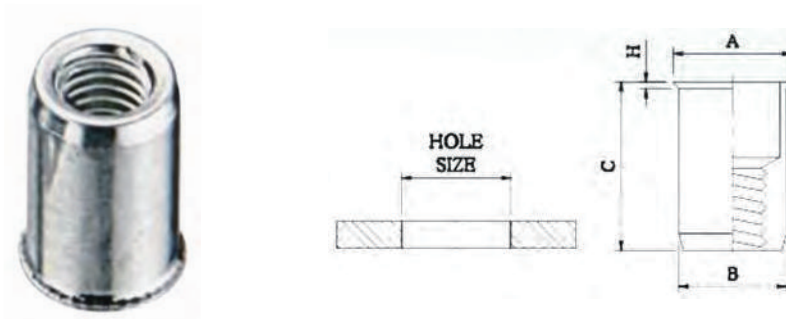

METRIC SIZE :MM

PART NO.	THREAD SIZE	GRIP RANGE	HOLE SIZE+0.1	A±0.3	B max	C±0.3	H±0.2
R2-S320	M3x0.5	0.5-2.0	5	5.90	4.97	9.00	0.50
R2-S425	M4x0.7	0.5-2.5	6	6.80	5.97	11.00	0.50
R2-S530	M5x0.8	0.5-3.0	7	8.00	6.97	12.00	0.50
R2-S630	M6x1.0	0.5-3.0	9	10.00	8.97	14.50	0.50
R2-S830	M8x1.25	0.5-3.0	11	12.00	10.97	16.50	0.50
R2-S1035	M10x1.5	1.0-3.5	13	14.10	12.97	19.50	0.60

C-S SERIES

STAINLESS STEEL 302,304,306, BLIND RIVET NUT,
COUNTERSUK HEAD, OPEN END

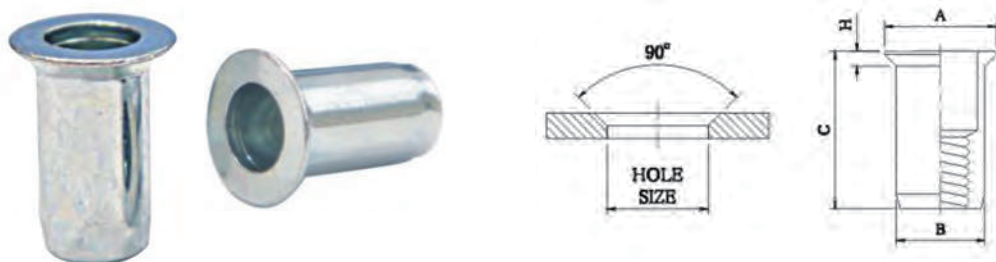

METRIC SIZE :MM

PART NO.	THREAD SIZE	GRIP RANGE	HOLE SIZE+0.1	A±0.3	B max	C±0.3	H±0.2
C-S435	M4x0.7	1.5-3.5	6	8.50	5.97	11.50	1.50
C-S540	M5x0.8	1.5-4.0	7	9.50	6.97	13.00	1.50
C-S645	M6x1.0	1.5-4.5	9	11.50	8.97	16.00	1.50
C-S845	M8x1.25	1.5-4.5	11	13.50	10.97	18.50	1.50

RK-S SERIES

STAINLESS STEEL 302,304,306, BLIND RIVET NUT,
COUNTERSUNK HEAD, OPEN END

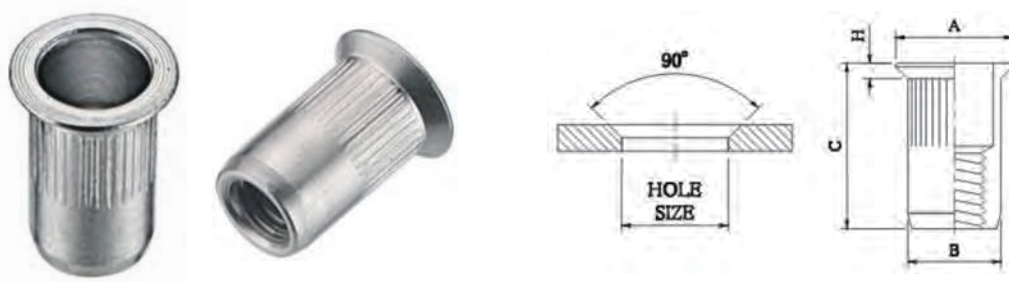

METRIC SIZE :MM

PART NO.	THREAD SIZE	GRIP RANGE	HOLE SIZE+0.1	A±0.3	B max	C±0.3	H±0.2
RK-S435	M4x0.7	1.5-3.5	6	8.50	5.97	11.50	1.50
RK-S540	M5x0.8	1.5-4.0	7	9.60	6.97	13.50	1.50
RK-S645	M6x1.0	1.5-4.5	9	11.60	8.97	16.00	1.50
RK-S845	M8x1.25	1.5-4.5	11	13.50	10.97	18.50	1.50
RK-S1045	M10x1.5	1.5-4.5	13	15.50	12.97	21.00	1.50

R-S SERIES

STAINLESS STEEL, BLIND RIVET NUT,
REDUCED HEAD, ROUND SHANK BODY, OPEN END

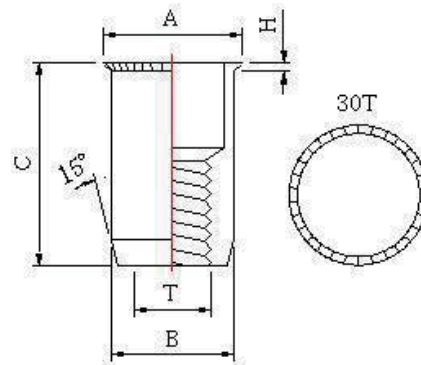

METRIC SIZE :MM

PART NO.	THREAD SIZE	GRIP RANGE	HOLE SIZE+0.15	A±0.3	B max	C±0.38	H±0.13
R-S3	M3x0.5	0.5-1.5	4.80	5.50	4.72	9.00	0.40
R-S4	M4x0.7	0.5-2.0	6.35	7.20	6.35	10.40	0.45
R-S5	M5x0.8	0.5-3.0	7.11	8.10	7.10	11.90	0.50
R-S6	M6x1.0	0.5-3.0	9.60	10.50	9.50	14.50	0.60
R-S8	M8x1.25	0.5-3.0	10.60	11.50	10.50	16.00	0.60

STAINLESS
STEEL

R2-SCL SERIES

STAINLESS STEEL, BLIND RIVET NUT,
REDUCED HEAD, ROUND SHANK BODY, CLOSED END

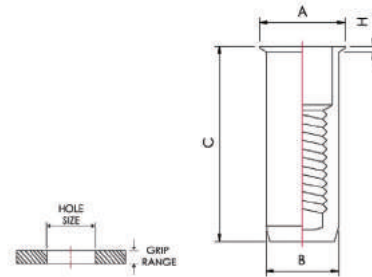

METRIC SIZE :MM

PART NO.	THREAD SIZE	GRIP RANGE	HOLE SIZE+0.1	A±0.3	B max	C±0.3	H±0.2
R2-SCL420	M4x0.7	0.5-2.0	6	7.00	5.97	16.00	0.50
R2-SCL530	M5x0.8	0.5-3.0	7	8.00	6.97	18.00	0.50
R2-SCL630	M6x1.0	0.5-3.0	9	10.00	8.97	21.00	0.50

RK2-S SERIES

STAINLESS STEEL, BLIND RIVET NUT,
REDUCED HEAD, ROUND SHANK WITH KNURLED BODY, OPEN END

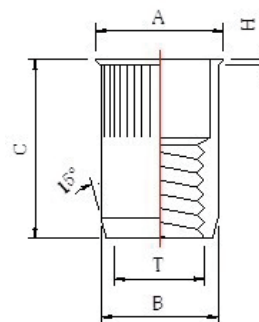

METRIC SIZE :MM

PART NO.	THREAD SIZE	GRIP RANGE	HOLE SIZE+0.15	A±0.3	B max	C±0.38	H±0.13
RK2-S3	M3x0.5	0.5-1.5	4.80	5.30	4.72	8.80	0.40
RK2-S4	M4x0.8	0.5-2.0	6.35	7.20	6.35	10.40	0.45
RK2-S5	M5x0.8	0.5-3.0	7.11	8.10	7.10	12.00	0.50
RK2-S6	M6x1.0	0.7-3.0	9.60	10.60	9.50	15.00	0.50
RK2-S8	M8x1.25	0.7-3.0	10.60	11.50	10.50	16.00	0.50

RK3-S SERIES

STAINLESS STEEL 302,304,316, BLIND RIVET NUT,
REDUCED HEAD, ROUND SHANK BODY, CLOSE END

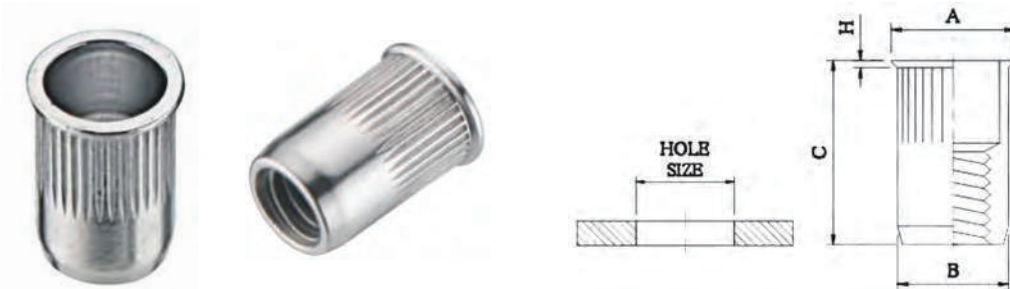

METRIC SIZE :MM

PART NO.	THREAD SIZE	GRIP RANGE	HOLE SIZE+0.1	A±0.3	B max	C±0.3	H±0.2
RK3-S320	M3x0.5	0.5-2.0	5	5.90	4.97	9.00	0.50
RK3-S425	M4x0.7	0.5-2.5	6	6.90	5.97	11.00	0.50
RK3-S530	M5x0.8	0.5-3.0	7	8.00	6.97	12.00	0.50
RK3-S630	M6x1.0	0.5-3.0	9	10.00	8.97	14.50	0.60
RK3-S835	M8x1.25	1.0-3.5	11	12.00	10.97	16.00	0.60
RK3-S1035	M10x1.5	1.0-3.5	13	14.20	12.97	19.30	0.60

KK-S SERIES

STAINLESS STEEL 302,304,316, BLIND RIVET NUT,
FLAT HEAD, ROUND SHANK BODY, OPEN END

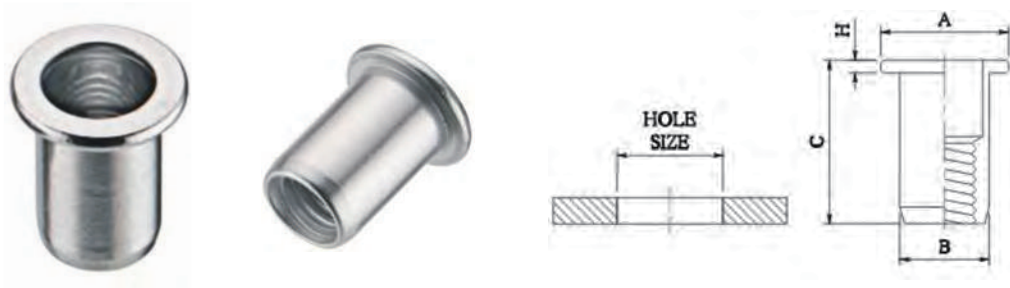

METRIC SIZE :MM

PART NO.	THREAD SIZE	GRIP RANGE	HOLE SIZE+0.1	A±0.3	B max	C±0.3	H±0.2
KK-S320	M3x0.5	0.5-2.0	5	8.00	4.97	10.0	0.8
KK-S425	M4x0.7	0.5-2.5	6	9.00	5.97	12.0	1.0
KK-S530	M5x0.8	0.5-3.0	7	10.00	6.97	13.0	1.0
KK-S630	M6x1.0	0.5-3.0	9	12.00	8.97	15.5	1.5
KK-S830	M8x1.25	0.5-3.0	11	15.00	10.97	17.5	1.5
KK-S1030	M10x1.5	1.0-3.5	13	17.00	12.97	21.0	2.0

FK2-S SERIES

STAINLESS STEEL 302,304,316, BLIND RIVET NUT,
FLAT HEAD, ROUND SHANK WITH KNURLED BODY, OPEN END

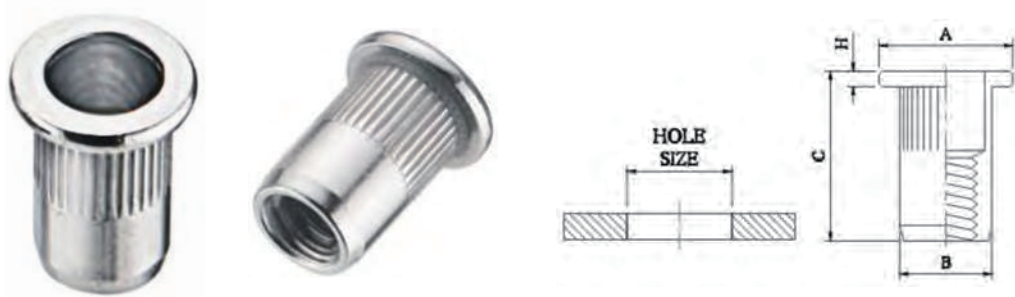

METRIC SIZE :MM

PART NO.	THREAD SIZE	GRIP RANGE	HOLE SIZE+0.1	A±0.3	B max	C±0.3	H±0.2
FK2-S320	M3x0.5	0.5-2.0	5	8.00	4.97	10.00	0.80
FK2-S420	M4x0.5	0.5-2.5	6	9.00	5.97	12.00	1.00
FK2-S530	M5x0.8	0.5-2.5	7	10.00	6.97	13.00	1.00
FK2-S535	M5x0.8	1.5-3.5	7	10.00	6.97	14.00	1.00
FK2-S630	M6x1.0	0.5-3.0	9	12.00	8.97	15.50	1.50
FK2-S635	M6x1.0	1.5-3.5	9	12.00	8.97	16.00	1.50
FK2-S830	M8x1.25	0.5-3.0	11	15.00	10.97	17.50	1.50
FK2-S835	M8x1.25	1.8-5.0	11	15.00	10.97	20.00	1.50
FK2-S1035	M10x1.5	1.0-3.5	13	17.00	12.97	21.00	2.00
FK2-S1050	M10x1.5	1.8-5.0	13	17.00	12.97	25.00	2.00

KK-SCL SERIES

STAINLESS STEEL 302,304,316, BLIND RIVET NUT,
FLAT HEAD, ROUND SHANK BODY, CLOSED END

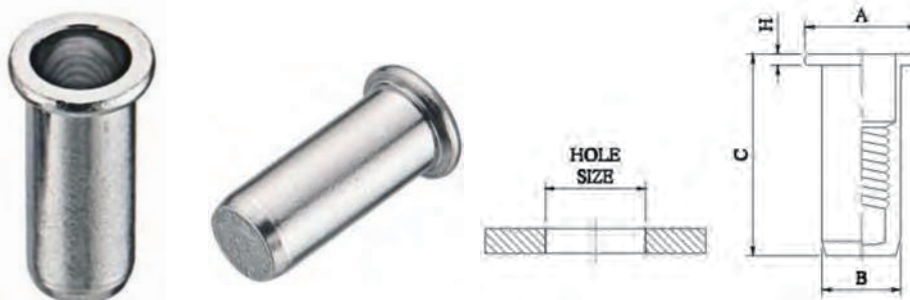

METRIC SIZE :MM

PART NO.	THREAD SIZE	GRIP RANGE	HOLE SIZE+0.1	A±0.3	B max	C±0.3	H±0.2
KK-SCL425	M4x0.7	0.5-2.5	6	9.00	5.97	16.50	0.80
KK-SCL530	M5x0.8	0.5-3.0	7	10.00	6.97	19.00	1.00
KK-SCL630	M6x1.0	0.5-3.0	9	12.00	8.97	22.50	1.50
KK-SCL835	M8x1.25	0.7-3.5	11	15.00	10.97	25.00	1.50
KK-SCL1040	M10x1.5	1.0-4.0	13	17.00	12.97	30.00	2.00

FK2-SCL SERIES

STAINLESS STEEL 302,304,316, BLIND RIVET NUT,
FLAT HEAD, ROUND SHANK WITH KNURLED BODY, CLOSED END

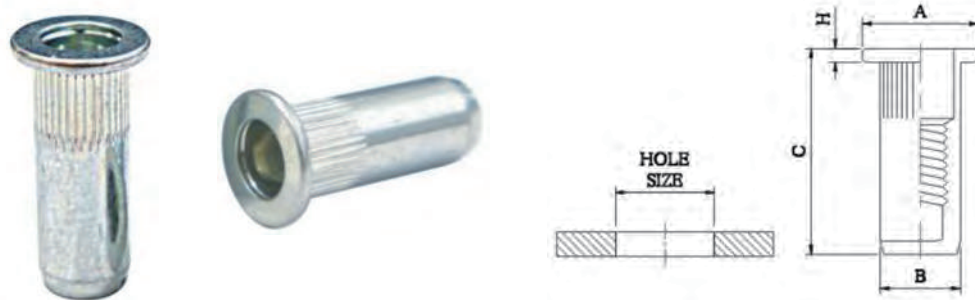

METRIC SIZE :MM

PART NO.	THREAD SIZE	GRIP RANGE	HOLE SIZE+0.1	A±0.3	B max	C±0.3	H±0.2
FK2-SCL425	M4x0.7	0.5-2.5	6	9.00	5.97	16.50	0.80
FK2-SCL530	M5x0.8	0.7-2.5	7	10.00	6.97	19.00	1.00
FK2-SCL630	M6x1.0	0.5-3.0	9	12.00	8.97	22.50	1.50
FK2-SCL830	M8x1.25	0.7-3.0	11	15.00	10.97	25.00	1.50
FK2-SCL1040	M10x1.5	1.0-3.5	13	17.00	12.97	30.00	2.00

RSH2-S SERIES

STAINLESS STEEL 302,304,316, BLIND RIVET NUT,
REDUCED HEAD, SEMI-HEX BODY, OPEN END

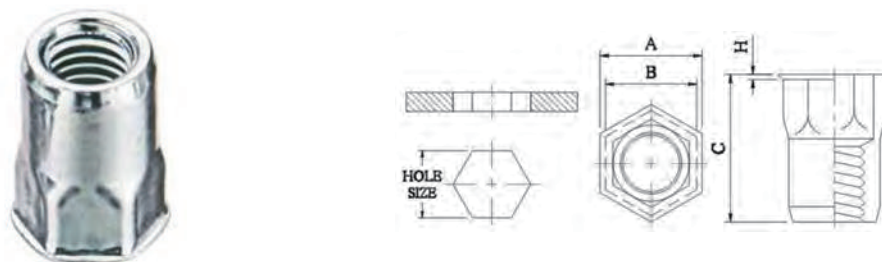

METRIC SIZE :MM

PART NO.	THREAD SIZE	GRIP RANGE	HOLE SIZE+0.1	A±0.3	B max	C±0.3	H±0.2
RSH2-S315	M3x0.5	0.3-1.5	5	5.80	4.97	8.50	0.40
RSH2-S420	M4x0.7	0.5-2.0	6	6.80	5.97	11.00	0.50
RSH2-S530	M5x0.8	0.5-3.0	7	8.00	6.97	11.80	0.60
RSH2-S630	M6x1.0	0.5-3.0	9	10.00	8.97	14.50	0.60
RSH2-S830	M8x1.25	0.5-3.0	11	12.00	10.97	16.00	0.60
RSH2-S850	M8x1.25	3.0-5.0	11	12.00	10.97	18.00	0.60
RSH2-S1035	M10x1.5	1.0-3.5	13	14.10	12.97	19.50	0.80

RSH2-SCL SERIES

STAINLESS STEEL 302,304,316, BLIND RIVET NUT,
REDUCED HEAD, SEMI-HEX BODY, CLOSED END

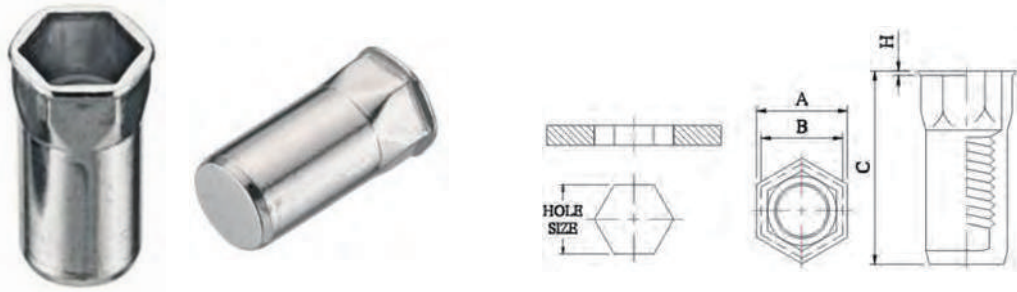

METRIC SIZE :MM

PART NO.	THREAD SIZE	GRIP RANGE	HOLE SIZE+0.1	A±0.3	B max	C±0.3	H±0.2
RSH2-SCL420	M4x0.7	0.5-2.0	6	6.80	5.97	16.00	0.50
RSH2-SCL530	M5x0.8	0.5-3.0	7	8.00	6.97	18.00	0.60
RSH2-SCL630	M6x1.0	0.5-3.0	9	10.00	8.97	21.00	0.60
RSH2-SCL830	M8x1.25	0.5-3.0	11	12.00	10.97	23.50	0.60
RSH2-SCL1035	M10x1.5	1.0-3.5	13	14.10	12.97	28.00	0.80
RSH2-SCL1045	M10x1.5	1.0-4.5	13	14.10	12.97	29.00	0.80
RSH2-SCL1060	M10x1.5	4.5-6.0	13	14.10	12.97	31.00	0.80

FSH-S SERIES

STAINLESS STEEL 302,304,316, BLIND RIVET NUT,
FLAT HEAD, SEMI-HEX BODY, OPEN END

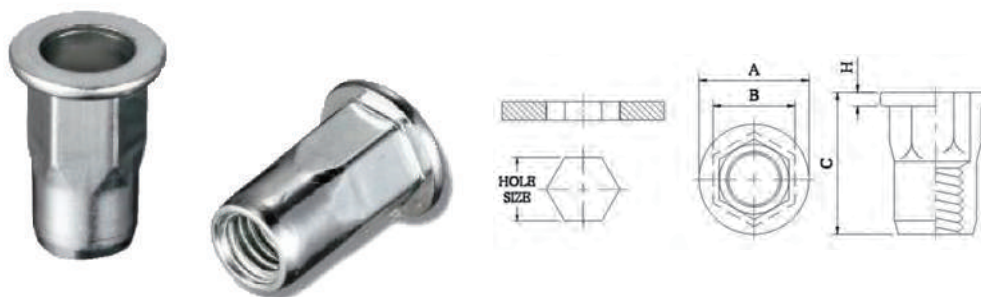

METRIC SIZE :MM

PART NO.	THREAD SIZE	GRIP RANGE	HOLE SIZE+0.1	A±0.3	B max	C±0.3	H±0.2
FSH-S435	M4x0.7	0.5-2.5	6	9.00	5.97	11.00	0.80
FSH-S530	M5x0.8	0.5-3.0	7	10.00	6.97	13.00	1.00
FSH-S630	M6x1.0	0.5-3.0	9	12.00	8.97	15.50	1.50
FSH-S830	M8x1.25	0.5-3.0	11	15.00	10.97	17.50	1.50
FSH-S1035	M10x1.5	3.0-6.0	13	19.00	12.97	26.00	2.00

FSH-SCL SERIES

STAINLESS STEEL 302,304,316, BLIND RIVET NUT,
FLAT HEAD, SEMI-HEX BODY, CLOSED END

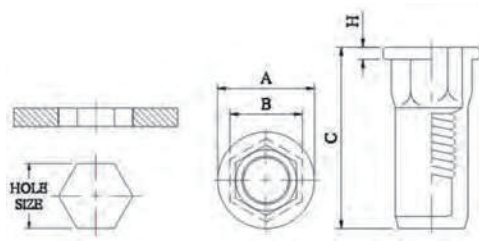

METRIC SIZE :MM

PART NO.	THREAD SIZE	GRIP RANGE	HOLE SIZE+0.1	A±0.3	B max	C±0.3	H±0.2
FSH-SCL425	M4x0.7	0.5-2.5	6	9.30	5.97	16.50	1.00
FSH-SCL530	M5x0.8	0.5-3.0	7	10.00	6.97	19.00	1.00
FSH-SCL630	M6x1.0	0.5-3.0	9	12.00	8.97	22.50	1.50
FSH-SCL830	M8x1.25	0.5-3.0	11	15.00	10.97	22.50	1.50

R2-A SERIES

ALUMINUM BLIND RIVET NUT REDUCED HEAD, OPEN END

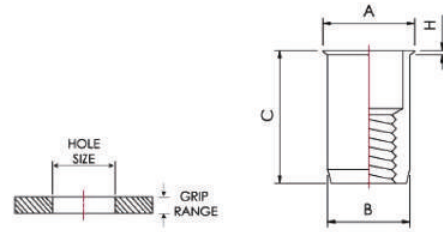

METRIC SIZE :MM

PART NO.	THREAD SIZE	GRIP RANGE	HOLE SIZE+0.1	A±0.3	B max	C±0.3	H±0.2
R2-A3	M3x0.5	0.3-1.5	5	5.60	4.97	8.50	0.35
R2-A4	M4x0.7	0.5-2.0	6	6.90	5.97	10.00	0.50
R2-A5	M5x0.8	0.5-3.0	7	8.00	6.97	12.00	0.50
R2-A5	M5x0.8	3.0-4.5	7	8.00	6.97	13.50	0.50
R2-A6	M6x1.0	0.5-3.0	9	10.00	8.97	15.00	0.50
R2-A6	M6x1.0	3.0-4.5	9	10.00	8.97	16.50	0.50
R2-A8	M8x1.25	0.5-3.0	11	12.00	10.97	16.00	0.50
R2-A8	M8x1.25	3.0-5.5	11	12.00	10.97	18.50	0.50

DN-A SERIES

ALUMINUM BLIND RIVET NUT FLAT HEAD, ROUND SHANK WITH KNURLED BODY, OPEN END

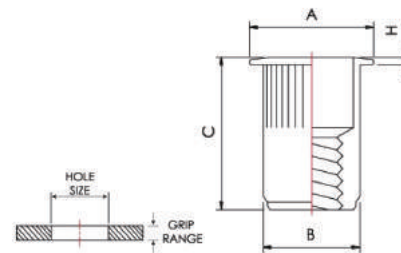

METRIC SIZE :INCH

PART NO.	THREAD SIZE	GRIP RANGE	HOLE SIZE+.006	A±.012	B max	C±.015	H±.005
DN-A632x80	6-32	.020-.080	.266	.390	.265	.450	.030
DN-A632x130	6-32	.080-.130	.266	.390	.265	.500	.030
DN-A832x80	8-32	.020-.080	.266	.390	.265	.450	.030
DN-A832x130	8-32	.080-.130	.266	.390	.265	.500	.030
DN-A1024x130	10-24	.020-.130	.297	.415	.296	.505	.030
DN-A1024x225	10-24	.130-.225	.297	.415	.296	.615	.030
DN-A1032x130	10-32UNF	.020-.130	.297	.415	.296	.505	.030
DN-A1032x225	10-32UNF	.130-.225	.297	.415	.296	.615	.030
DN-A1/4x165	1/4-20	.027-.165	.391	.500	.390	.610	.030
DN-A1/4x260	1/4-20	.165-.260	.391	.500	.390	.710	.030
DN-A5/16x150	5/6-18	.027-.150	.531	.685	.530	.725	.035
DN-A5/16x312	5/6-18	.150-.312	.531	.685	.530	.840	.035
DN-A3/8x150	3/8-16	.027-.150	.531	.685	.530	.725	.035
DN-A3/8x312	3/8-16	.150-.312	.531	.685	.530	.840	.035

FK2-A SERIES

ALUMINUM BLIND RIVET NUT

FLAT HEAD, ROUND SHANK WITH KNURLED BODY, OPEN END

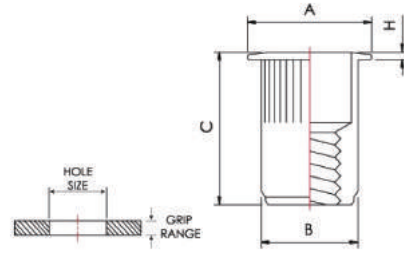

METRIC SIZE :MM

PART NO.	THREAD SIZE	GRIP RANGE	HOLE SIZE+0.1	A±0.3	B max	C±0.3	H±0.2
FK2-A3	M3x0.5	0.5-2.0	5	8.00	4.97	10.50	0.70
FK2-A4	M4x0.7	0.5-2.5	6	9.00	5.97	11.00	0.80
FK2-A5	M5x0.8	0.5-3.0	7	10.00	6.97	13.00	1.00
FK2-A6	M6x1.0	0.7-3.0	9	13.00	8.97	16.50	1.50
FK2-A8	M8x1.25	0.7-3.0	11	16.00	10.97	18.00	1.50
FK2-A10	M10x1.50	1.0-4.5	13	19.00	12.97	24.00	2.00

KK-A SERIES

ALUMINUM BLIND RIVET NUT

FLAT HEAD, ROUND SHANK WITH KNURLED BODY, OPEN END

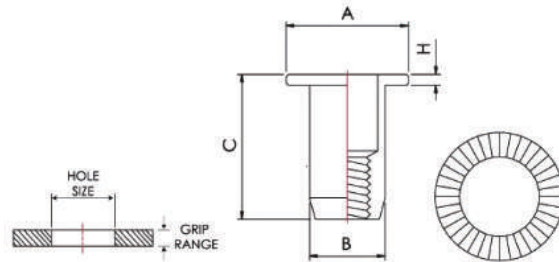

METRIC SIZE :MM

PART NO.	THREAD SIZE	GRIP RANGE	HOLE SIZE+0.1	A±0.3	B max	C±0.3	H±0.2
KK-A3	M3x0.5	0.5-2.0	5	8.00	4.97	9.50	0.70
KK-A4	M4x0.7	0.5-2.5	6	9.00	5.97	11.20	0.80
KK-A5	M5x0.8	0.5-3.0	7	10.00	6.97	12.80	1.00
KK-A6	M6x1.0	0.7-3.0	9	13.00	8.97	16.00	1.50
KK-A8	M8x1.25	0.7-3.0	11	15.00	10.97	18.00	1.50
KK-A10	M10x1.5	1.0-3.5	13	17.00	12.97	20.00	1.50

F-A SERIES

ALUMINUM BLIND RIVET NUT FLAT HEAD, ROUND SHANK BODY, OPEN END

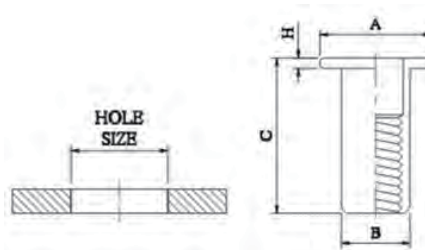

METRIC SIZE :MM

PART NO.	THREAD SIZE	GRIP RANGE	HOLE SIZE+0.15	A±0.3	B max	C±0.38	H±0.13
F-A520	M5x0.8	0.25-2.0	6.75	10.00	6.30	14.00	1.00
F-A620	M6x1.0	0.5-2.0	8.50	13.40	8.43	17.40	1.50
F-A650	M6x1.0	3.5-5.0	8.50	13.40	8.43	20.00	1.50
F-A1030	M10x1.5	1.0-3.0	12.50	19.50	12.44	22.20	2.23

METRIC SIZE :INCH

PART NO.	THREAD SIZE	GRIP RANGE	HOLE SIZE+.006	A±.012	B max	C±.015	H±.005
F-A632x75	6-32	.010-.075	.189	.325	.189	.470	.032
F-A632x120	6-32	.075-.120	.189	.325	.189	.532	.032
F-A832x75	8-32	.010-.075	.221	.357	.221	.470	.032
F-A832x120	8-32	.075-.120	.221	.357	.221	.532	.032
F-A1032x80	10-32UNF	.010-.080	.250	.406	.250	.569	.038
F-A1032x130	10-32UNF	.080-.130	.250	.406	.250	.632	.038
F-A1/4-80	1/4-20	.020-.080	.332	.475	.332	.683	.058
F-A1/4-140	1/4-20	.080-.140	.332	.475	.332	.745	.058
F-A1/4-200	1/4-20	.140-.200	.332	.475	.332	.808	.058
F-A5/16-125	5/16-18	.030-.125	.413	.665	.413	.812	.062
F-A5/16-200	5/16-18	.125-.200	.413	.665	.413	.937	.062
F-A3/8-115	3/8-16	.030-.115	.490	.781	.490	.932	.088
F-A3/8-200	3/8-16	.115-.200	.490	.781	.490	1.026	.088





Online Catalogue

VIM International Enterprise Co., Ltd.

E-mail: vimcom@ms48.hinet.net

Web: www.evim.com.tw / www.vim.com.tw